

PRODUCT CODE

GF-PRO

PRODUCT DESCRIPTION

The Snow Switch Model GF-PRO is an automatic snow and ice melting control system. Utilizing standard snow and ice sensors (sold separately), applications include snow and ice detection and melting for pavement, sidewalks, loading docks, roofs, gutters and downspouts in commercial and residential environments.

The GF-PRO interfaces with up to two standard sensors to meet site requirements. Roof or mast mounted, CIT-1 Aerial Snow Sensor can be paired with the GIT-1 Gutter Ice Sensor (gutter deicing applications) or the SIT-6E Pavement-Mounted Snow and Ice Sensor (trafficked surface applications). All three sensors detect precipitation as snow at temperatures below 38°F (3.3°C), saving energy and ensuring thorough snow and ice melting.

Since 1968, these sensors have been the industry's most versatile and cost-effective automatic snow melting control sensors.

The GF-PRO features built-in 30mA, self-testing Ground Fault Equipment Protection (GFEP), digitally filtered to minimize false tripping. A ground fault condition must be manually reset using the Test/Reset switch before heater operation can continue. The GF-PRO uses both automatic and manual-override operator controls. The adjustable Hold-On timer can continue heater operations up to 8 hours after snow or ice conditions end to ensure complete melting and a dry surface.

The heater Cycle control button allows manual initiation or cancelation of a heating cycle.

The GF-PRO weighs only 3 pounds and measures 5 1/2" (L) x 8 1/8" (W) x 4 3/8" (H).

The GF-PRO is a capable snow and ice control for medium-sized applications whose features and power requirements do not require an APS or EUR Series control panel. For complete information describing application, installation, and features, please contact Warmup.

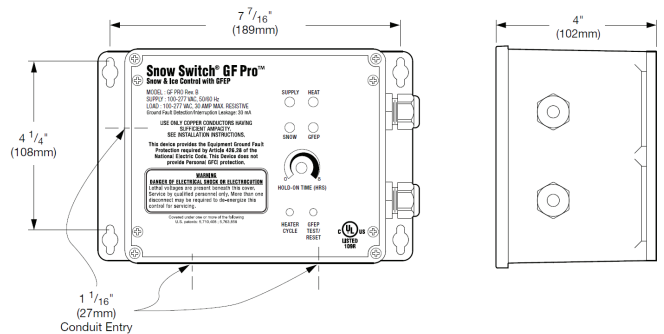

SPECIFICATION

Area of Use	Non-hazardous locations
Approval	cULus
ENCLOSURE	
Protection	IP 66, NEMA 4X
Cover attachment	Polycarbonate with machine screws
Entries	2 x 3/4" entry (bottom right) for NEC Class 2 connections 3 x 1-1/16" entries (bottom left) for supply and load power
Material	Polycarbonate
Mounting	Wall mounted
Dimensions	5 1/2" (L) x 8 1/8" (W) x 4 3/8" (H) / 140mm (L) x 207mm (W) x 112mm (H)
CONTROL	
Supply voltage	100 - 277 VAC; 50/60 Hz
Load	30 amp maximum resistive
Contact type	2 Form A
Weight	3 Pounds (not including sensors)
Maximum ratings	Voltage: 277 VAC Current: 30 amps
Heater hold-on timer	0 to 8 hours; actuated by snow stopping or toggle switch
System test	Switch toggles heater contact on and off. If temperature exceeds optional high limit thermistor (45°F), heater shuts off to reduce costs and prevent damage.
FRONT PANEL INTERFACE	
Status indicator	SUPPLY (green): Power on HEAT (yellow): Heating cycle in progress SNOW (yellow): Sensor(s) detect snow GFEP (red): Ground Fault condition GFEP (red, flashing): Failed GFEP (red, rapid flashing): GFEP test in progress
SNOW/ICE SENSORS	
Maximum quantity	2 ETI sensors
Circuit type	NEC Class 2
Lead length	Up to 500 ft (152 m) using 18 AWG 3-wire jacketed cable Up to 2,000 ft (609 m) using 12 AWG 3-wire jacketed cable
WIRE AND CABLE RATINGS	
Power cable	Size for heater load (30 amps maximum)
Sensor wiring	#18 AWG jacketed, 3-conductor
Heater cable	Size for maximum heater load
Remote wiring	#22 AWG jacketed, 2-conductor
GROUND FAULT EQUIPMENT PROTECTION (GFEP)	
Set point	30mA
Automatic self-test	GFEP verified before contactors operate; GFEP runs on start-up and every 24 hours
Manual Test/Reset	Test/Reset switch on front panel
ENVIRONMENTAL	
Operating temperature	-31°F to 113°F (-35°C to 45°C)
Storage temperature	-67°F to 167°F (-55°C to 75°C)

PRODUCT LISTING

Code	Description	Amp (A)
COMMBOX-600	Plug-and-Play outdoor controller with 4 x 50A/3pole contactors allowing for a total load of 600A with a minimum power supply of 60A. Comes in LED enclosure with GFEP protection, built-in Digital controller and ground temperature sensor.	600A
AIRsense	Outdoor moisture and temperature sensor, supplied with mounting bracket.	N/A
APS-3C	Snow Melting Controller with incl. slab sensor and built-in dry contacts for EMC and remote control. Rated 208-277V single phase.	N/A
SIT-6E	Surface-mounted snow and ice sensor used with APS series panels. Detects moisture and temperatures and triggers below 38°F for energy-efficient operation. Easy mounting in slabs with multiple conduit connections.	N/A
CIT-1	The maintenance free CIT sensors activate snow melting systems below 38°F and provide automatic triggering of APS series panels. Mast or roof mounting.	N/A
GIT-1	GIT-1 gutter sensor for APS-3C panel. Measures moisture & temperature. Active below 38F.	N/A
GF-PRO	Automatic Controller with GFEP and GF Load	30A

WARRANTY & MAINTENANCE

When installed according to the installation manual, the GF-PRO is covered with Warmup's 1-year manufacturer warranty.

TECHNICAL SUPPORT

Warmup is available 24/7/365 at (888) 927-6333.

For quotes, layouts and specific technical information, contact us at:

Warmup USA

52 Federal Rd #1F, Danbury, CT 06810
(888) 927-6333
us@warmup.com

Warmup CANADA

374 Wellington St W, Toronto, ON M5V 1E3
(905) 990-2075
ca@warmup.com

RELATED PRODUCTS

- CIT-1 Aerial Snow Sensor - see WSC-1104
- GIT-1 Gutter Ice Sensor - see WSC-1204
- SIT-6E Pavement Mounted Snow Sensor - see WSC-1304
- APS-3C Snow Melting and Gutter De-icing - see WSC-1404