

DESCRIPTION

This durable corrosion resistant enclosure is used in pipe freeze protection applications to create a safe enclosure for electrical connection between the power supply and max. 3 heating cable(s). It is approved by CSA for use in hazardous and non-hazardous areas.

The PTBS-GET provides a silicone-free installation providing a waterproof enclosure for cable connections. The stand provides guided entry into the enclosure for the heating cable and positions the junction box clear of any pipe insulation.

The spring clamp terminals provide safe, reliable, maintenance-free operation. PTBS-GET contains all the necessary materials for a complete certified installation.



SPECIFICATION

PRODUCT CODE	SR-SFIT-BOX-S (PTBS-GET)
OPERATING TEMPERATURES	-40°F to +212°F / -40°C to +50°C
IP RATING	IP67
MATERIAL	Glass reinforced Polyester, Fire Retardant
USAGE	Class1.Div2,Group A,B,C,D Class2.Div2,Group E,F,G Class3.Div2

DIMENSIONS

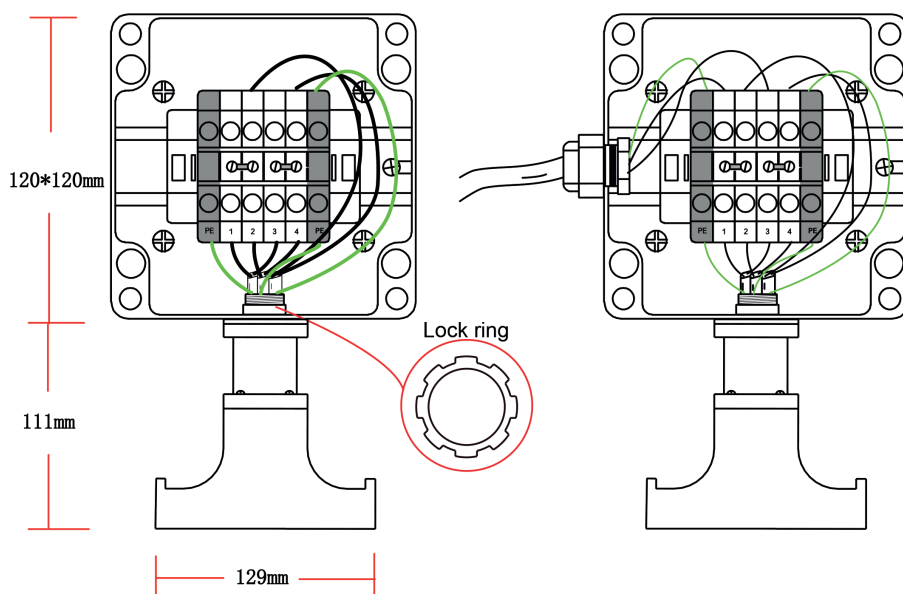

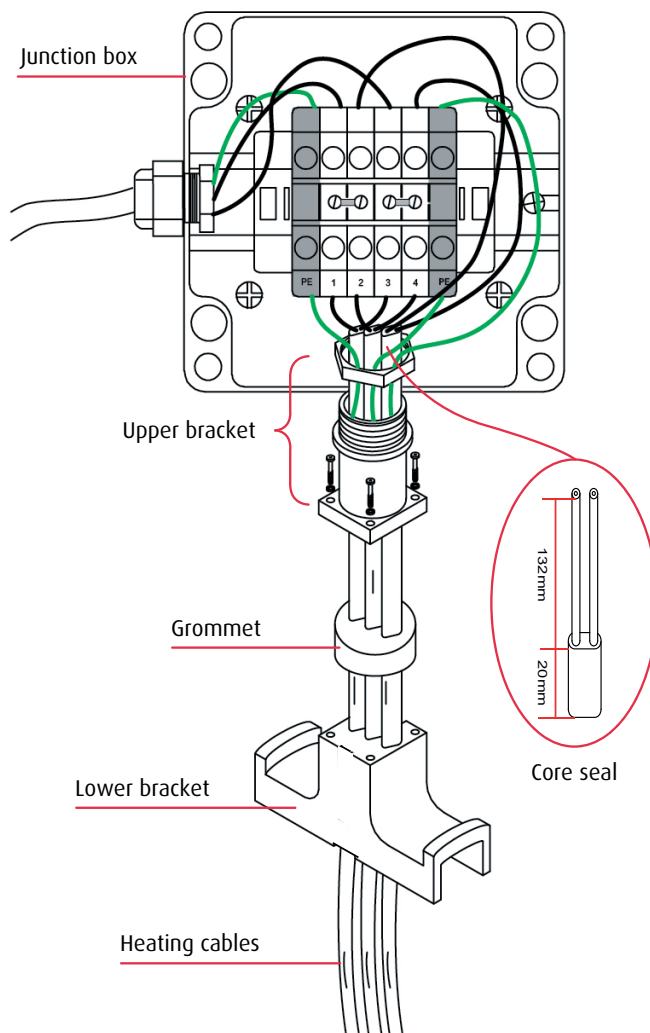

INSTALLATION

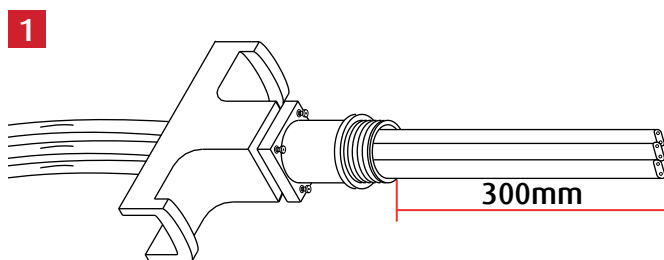

Push the heating cable(s) through the lower bracket, leaving 300mm of heating cable exposed.

NOTE: Max. 3 heating cables.

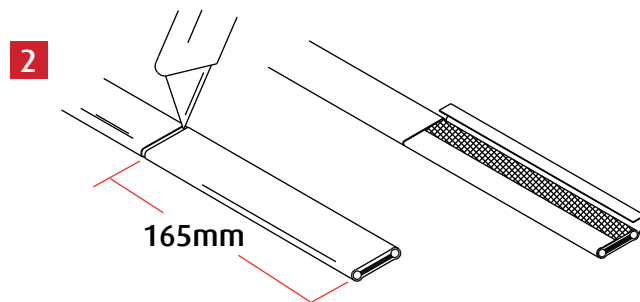

Measure 165mm in from the end of the cable and carefully cut the outer sheath. Bend the cable to break sheath. Next, gently slice the outer sheath up the centre between the first cut mark and the end of cable. Bend the cable to break sheath and remove the sheath from the heating cable.

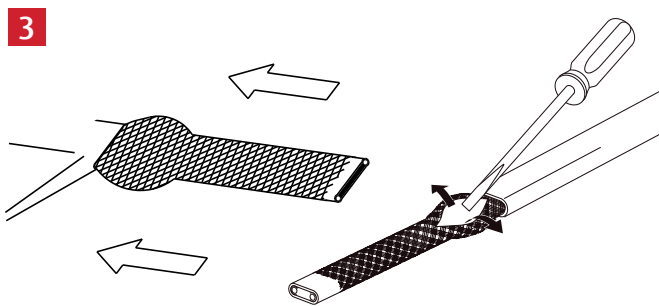

Move the braid back toward the outer sheath. At the base of the braid where it meets the outer sheath, gently separate the braid to make an opening.

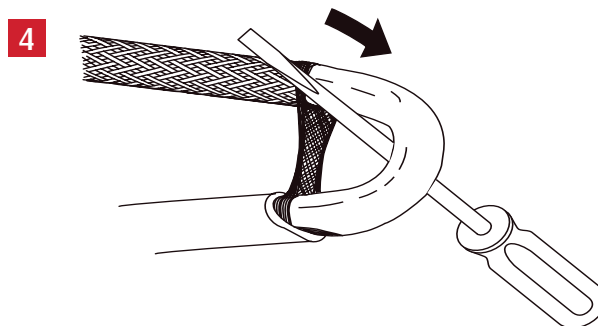

While bending the heating cable, work the heating cable through the braid opening and then pull the braid tight and twist.

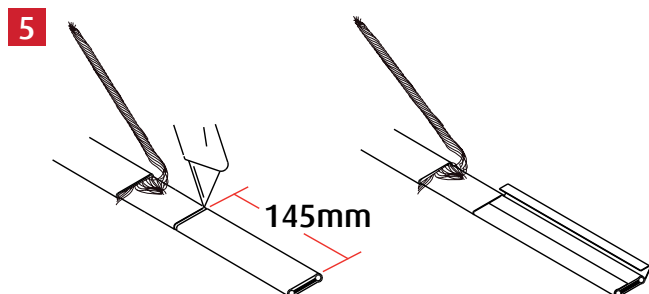

Measure 145mm in from the end of the cable and carefully cut the heating cable insulation. Bend the cable to break the insulation. Next, gently slice the insulation up the center between the first cut and the end of cable. Bend cable to break the insulation and then remove.

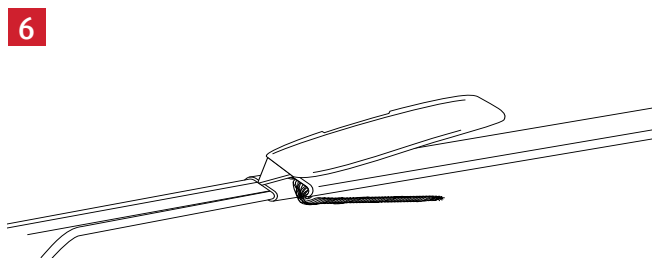

Separate the bus wires from the self-regulating matrix material with a utility knife.

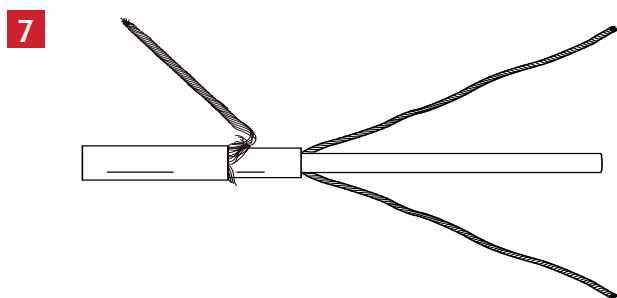

Peel back the exposed bus wires. **DO NOT CUT THE BUS WIRES.**

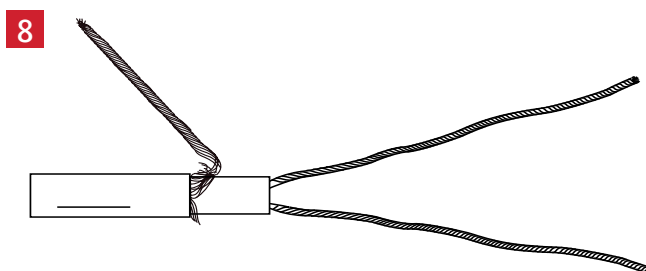

Cut the exposed self-regulating matrix back to the heating cable insulation. **DO NOT CUT THE BUS WIRES.**

9

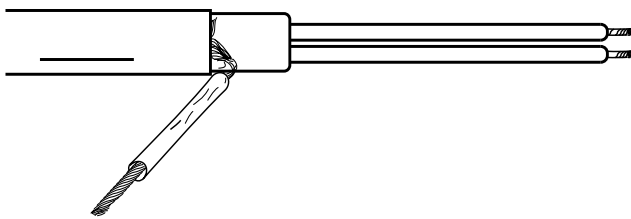

Insert the bus wires through heat shrink tubes. Insert the braiding through the ground tube.

NOTE: If there is a second or third cable, repeat step 2 to step 9.

10

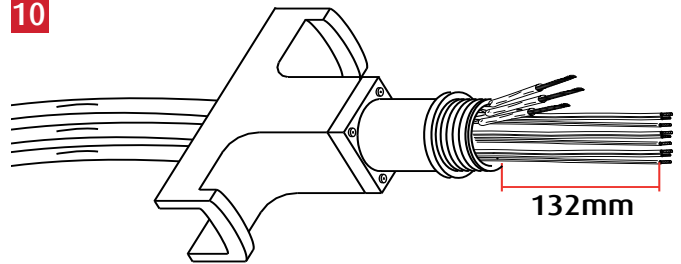

Insert the prepared cables into the lower bracket ensuring they extend 132mm beyond the bracket, and then tighten the 4 screws.

11

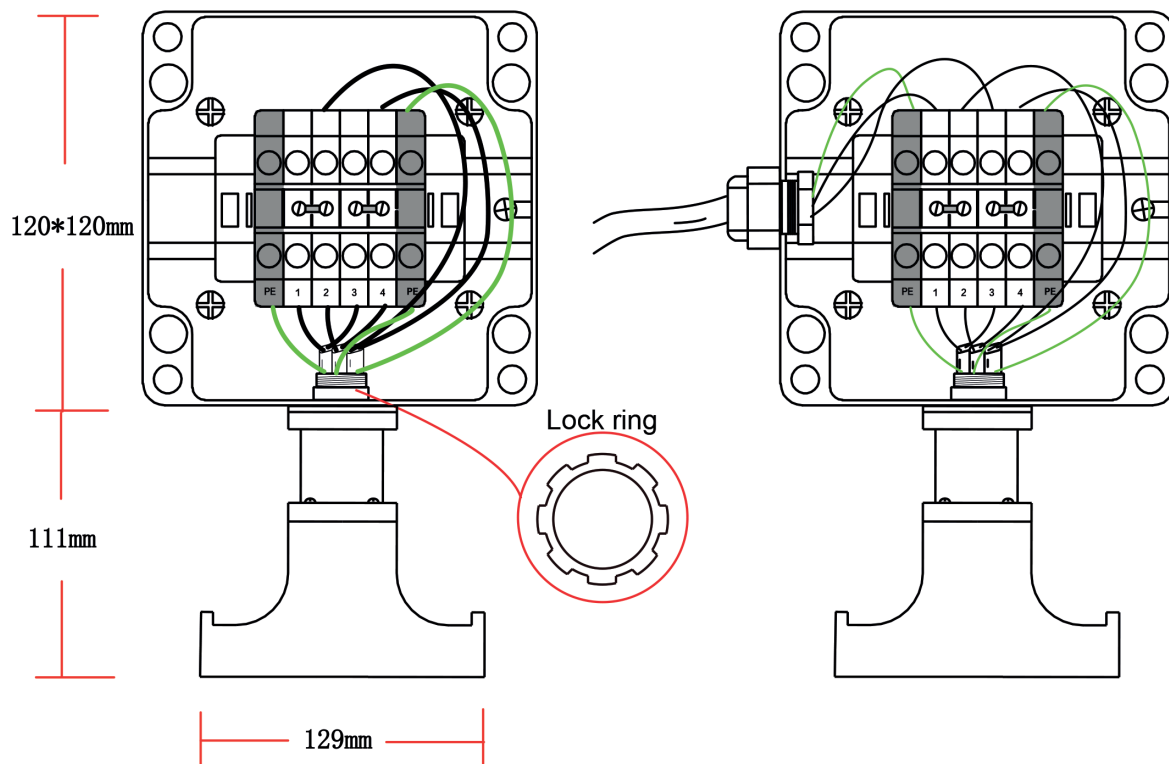

Insert the cables through the base of the junction box. Secure the lower bracket to the junction box using the lock ring.

Connect the bus wires (black) and ground wires (green) to the terminals as shown.

Connect the power supply wires (black) and ground wires (green) to the terminals as shown.